

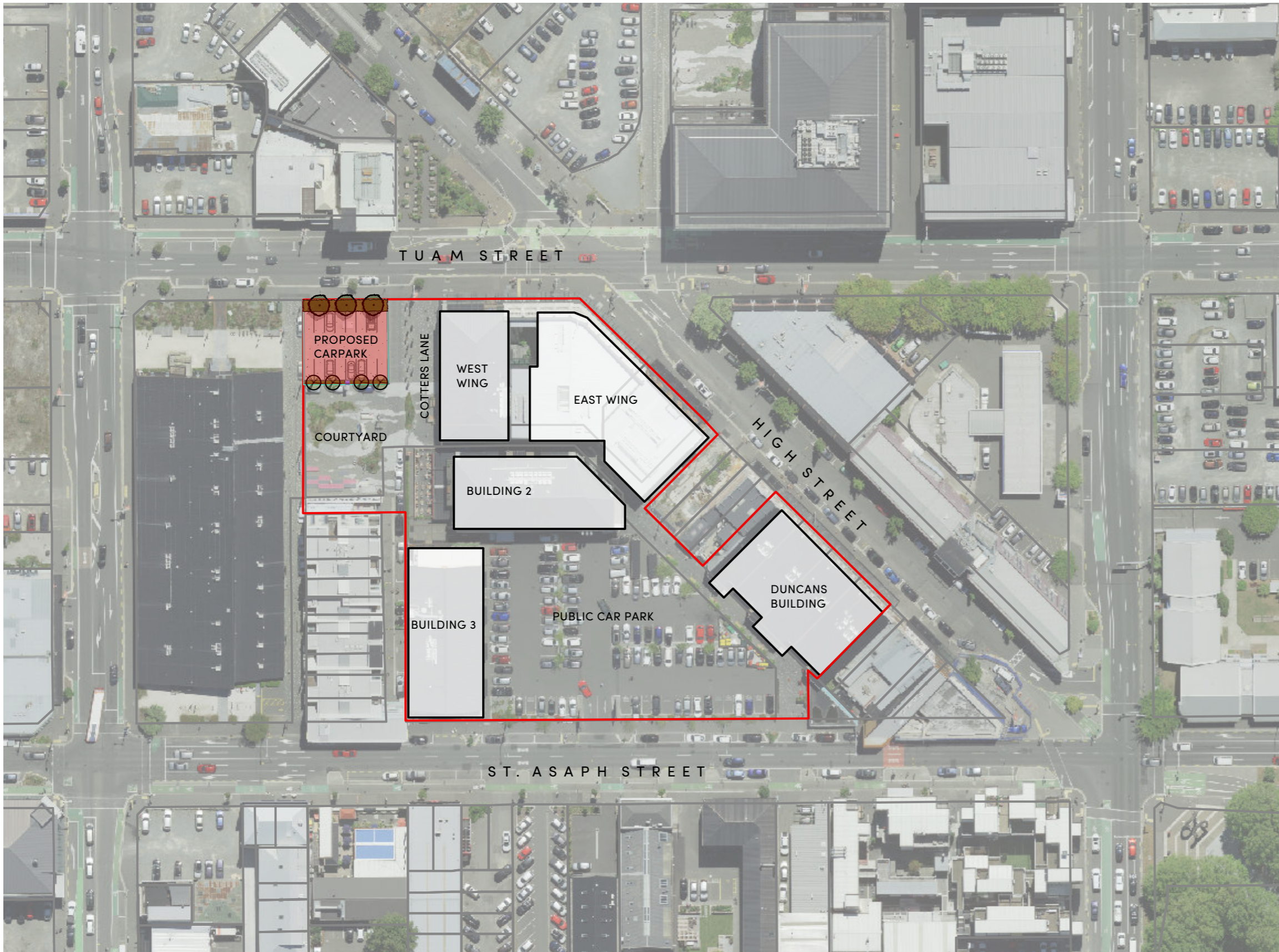

01.SITE PLAN



Key

- Proposed carpark at 230 Tuam Street (405m²)
 - Existing Buildings
 - Site Boundary
- Approx site area = 9300m²



02. DETAILED PLAN

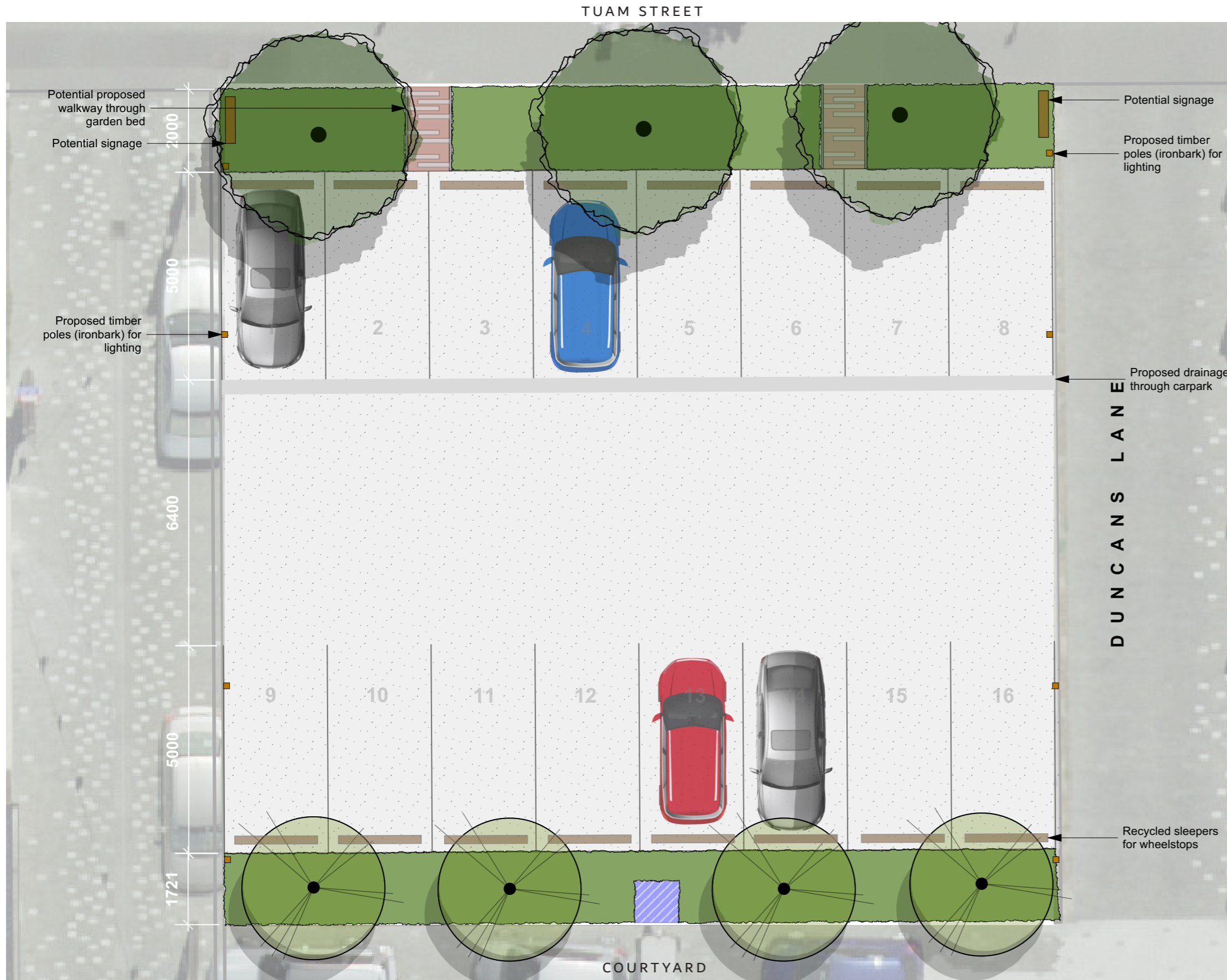

Key

- Proposed Trees along north/south site boundaries
- Proposed Landscaping strips
- Asphalt/Standard Concrete for carparking surfacing
- 16x Proposed Carparks
- Approximate location of existing utility pole

WIDER CONTEXT MAP.

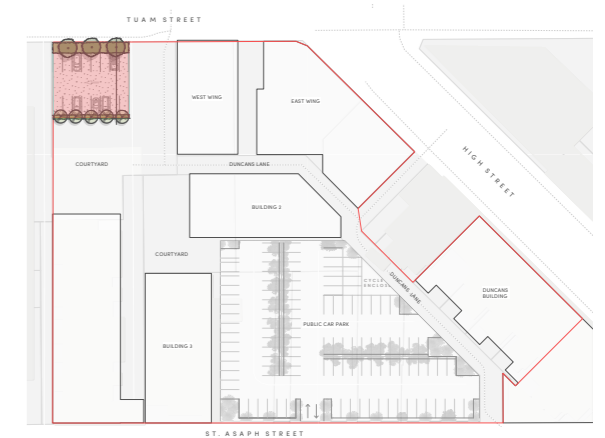



03. SUPPORTING VISUALS

Cross section A-A'

Cross section illustrating the general forms/heights and spatial arrangement of the proposed carpark with specific proposed design features

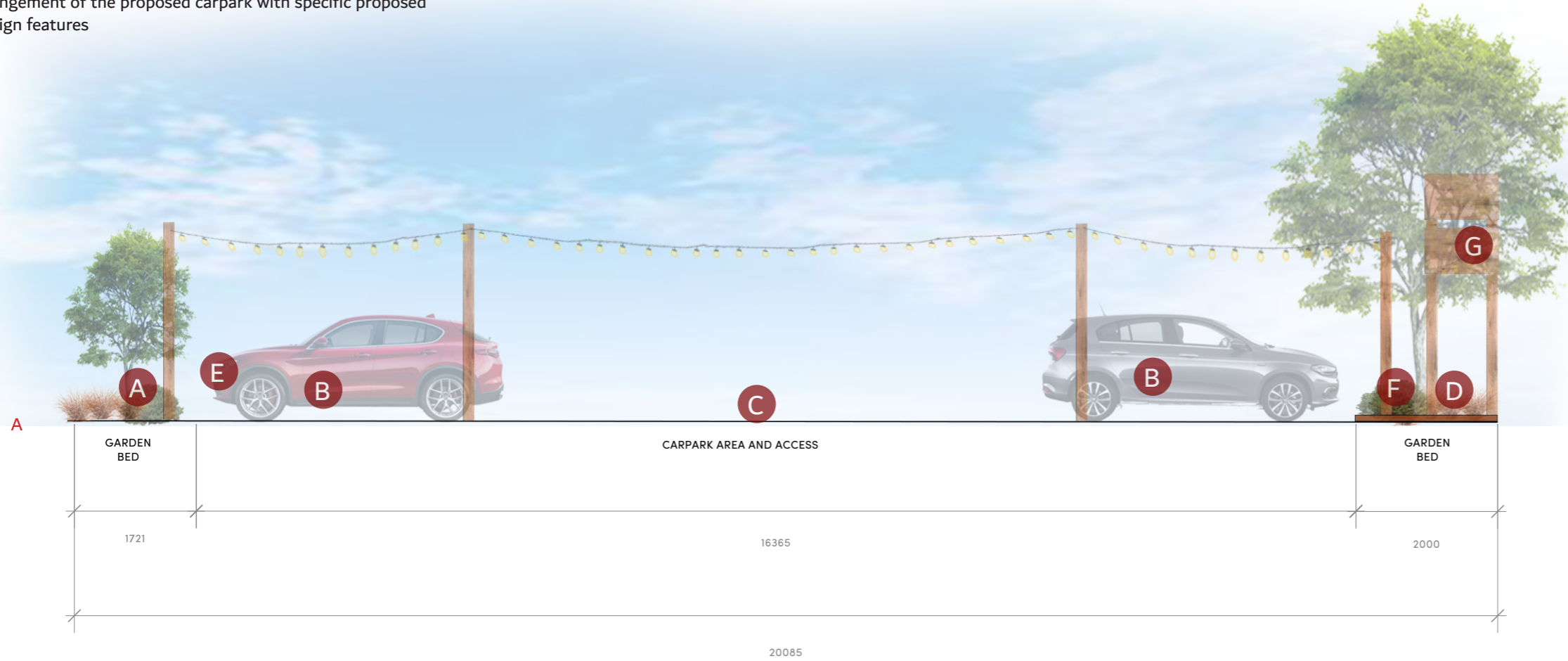

Key

- A** 1m wide planting bed with smaller tree species
- B** 5m long carpark area
- C** 6.4m wide carpark access zone
- D** Road frontage planting bed with 800mm high hedging species and larger specimen tree
- E** Wheelstops - recycled railway sleepers
- F** Reused Ironbark timber posts with festoon lights
- G** Approximate location of proposed signage

LOCATION MAP.

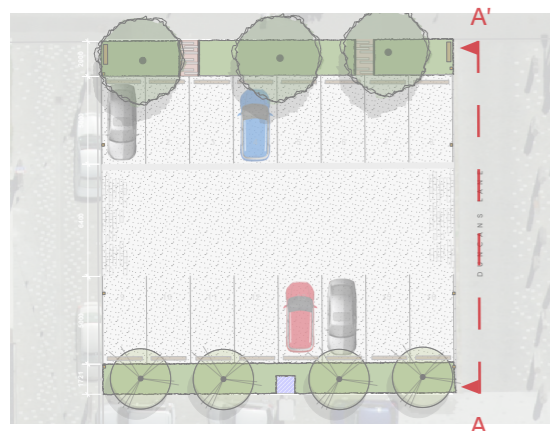

1 ELEVATION A - A'
SCALE 1:75



04. INDICATIVE TREE / PLANT SPECIES

Indicative Tree/Plant species

EXISTING

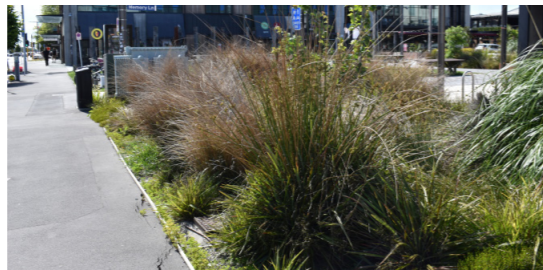

SPECIES



Libertia ixiodes
NZ Iris

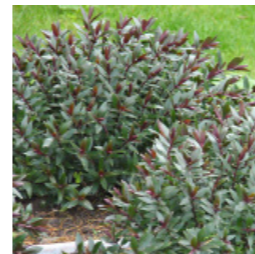

Hebe Pretty n Pink
Hebe



Carex testacea
NZ Sedge



Phormium Emerald Green
Dwarf Mountain Flax

TREES



Carpinus Fastigata
Upright hornbeam



Magnolia Grandiflora
Evergreen Magnolia



Sophora spp.
Kowhai



Liriodendron tulipifera
Tulip Tree

LOCATION MAP.

