

21 June 2019

Mr Andy Langford

fyi-request-10456-7adcf332@requests.fyi.org.nz

Dear Mr Langford

Local Government Official Information and Meetings Act 1987 Request – Dunedin City Council boundary maps.

I refer to your official information request dated 4 June 2019 for information about the Dunedin City Council boundaries, in relation to the Dog Control Bylaw maps and what authority (Dunedin City Council or the Otago Regional Council) which controls the areas.

You specifically requested that Council:

- (a) Explain what changes occurred, and when they occurred, to remove authority over the area between MHWS and MLWS from the ORC and vest it in the DCC.
- (b) As that would be a formal process please also provide copies of all relevant documentation (or links if the information is already publicly available on the internet).

In response to (a), I can advise that Council did have a boundary that applied to the Mean High-Water Springs (MHWS). The boundary is now to the Mean Low Water Springs (MLWS). This change occurred during a review of the electoral boundaries for Dunedin City in 2016, as determined by the Local Government Commission.

In response to (b), I have attached the Community Board boundary maps for the Dunedin City area, and the descriptive plan for Dunedin City, which notes the approval to the boundary changes from MHWS to MLWS.

I trust that this answers your request.

Yours sincerely



Lauren McDonald

Governance Support Officer

Encls: 3

Notes:

1. Coordinates are in terms of New Zealand Transverse Mercator 2000 (NZTM).
2. Where a boundary is shown along a river or road it follows the middle line of the physical river or legal road unless otherwise shown.
3. Where a boundary is shown along a railway it follows the middle line of the cadastral railway unless otherwise shown.
4. All seaward boundaries follow the line of mean low water springs but cross the mouths of all rivers, streams, inlets and estuaries unless otherwise shown.

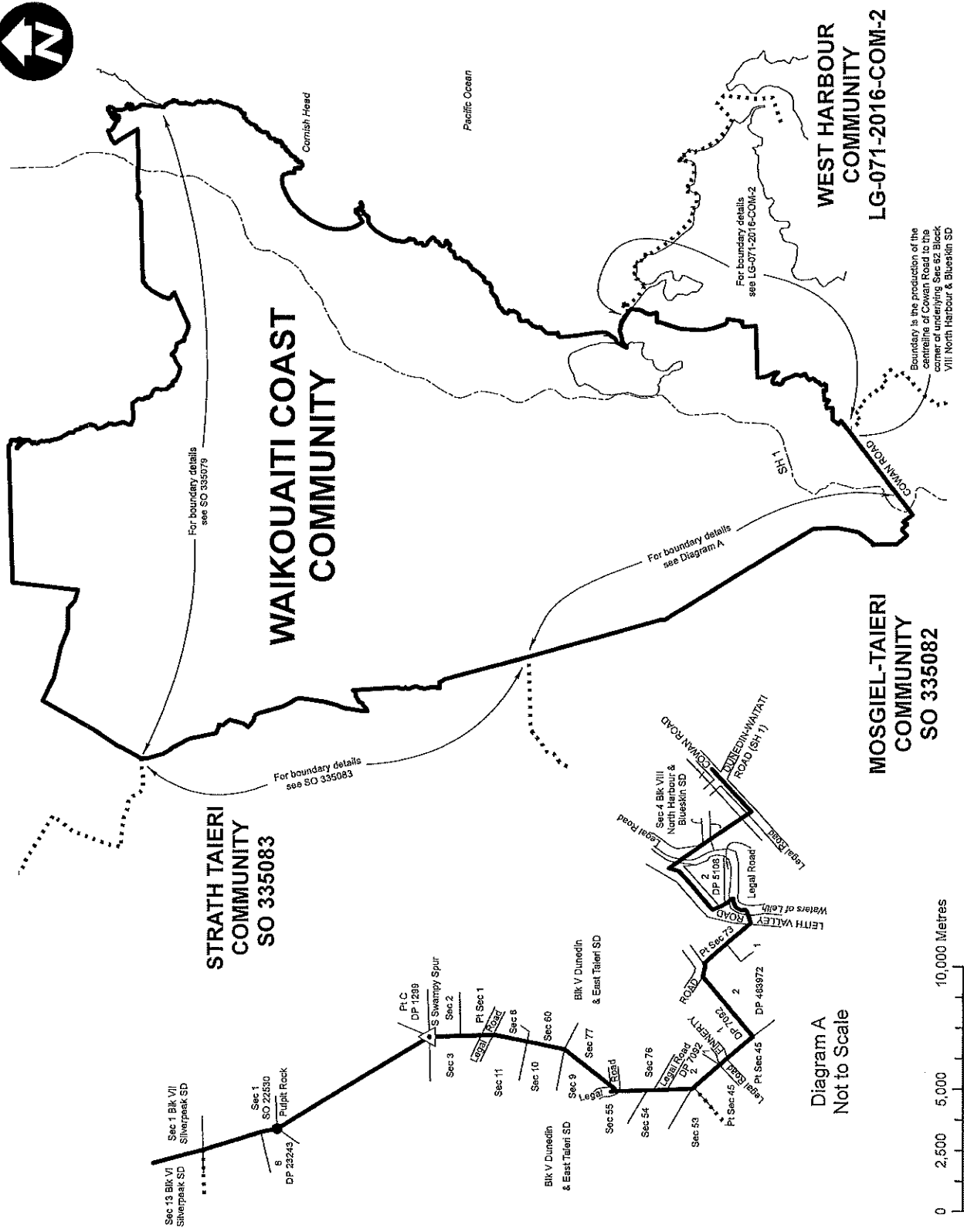

LG-071-2016-Com-1

TERRITORIAL AUTHORITY: Dunedin City
 Compiled by Jacobs New Zealand Limited
 Scale 1:160,000 at A3 Date: June 2016

DUNEDIN CITY
 WAIKOUAITI COAST COMMUNITY

Land District: Otago
 File IZ048800



Notes:

1. Coordinates are in terms of New Zealand Transverse Mercator 2000 (NZTM).
2. Where a boundary is shown along a river or road it follows the middle line of the physical river or legal road unless otherwise shown.
3. Where a boundary is shown along a railway it follows the middle line of the cadastral railway unless otherwise shown.
4. All seaward boundaries follow the line of mean low water springs but cross the mouths of all rivers, streams, inlets and estuaries unless otherwise shown.

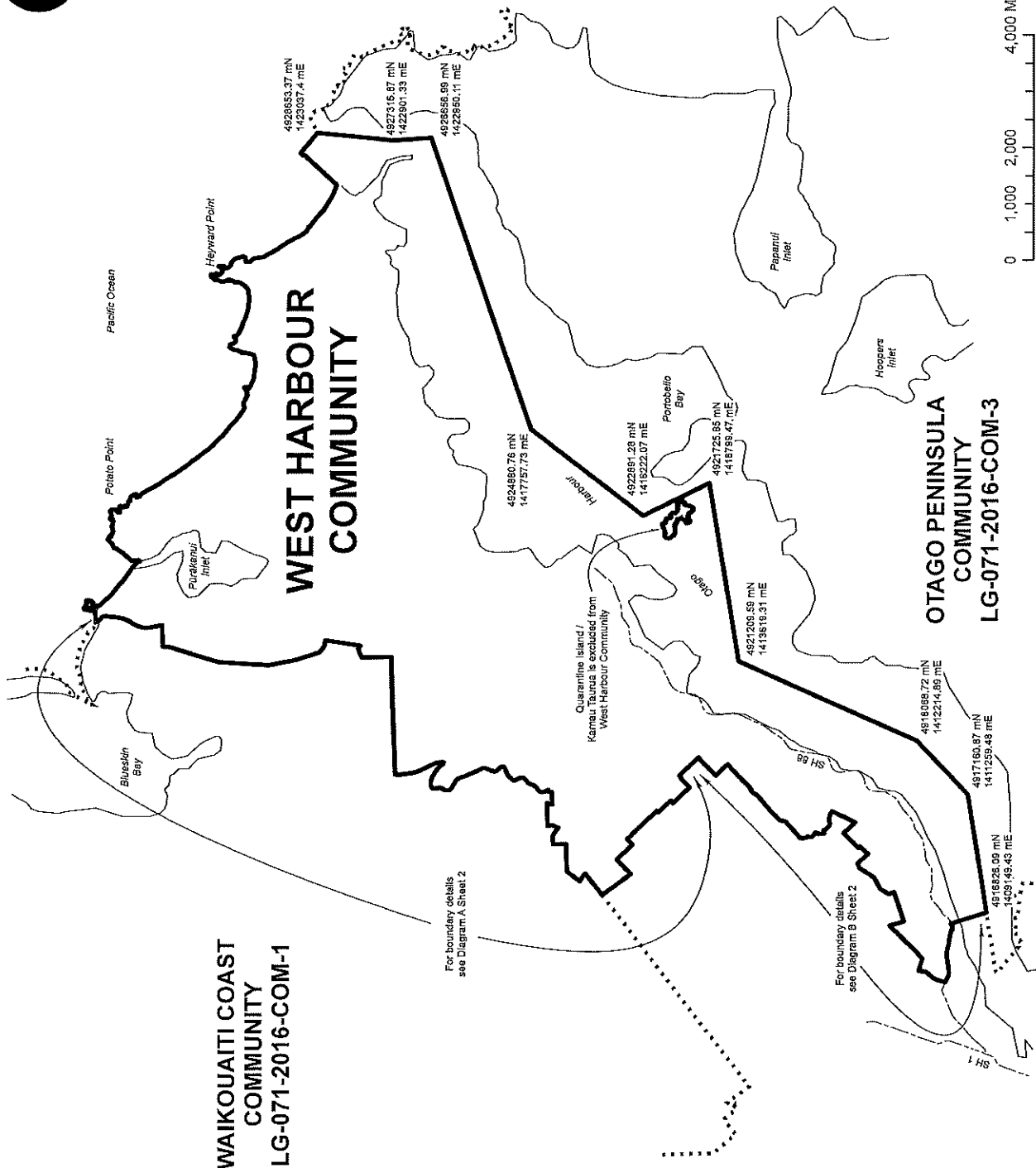

**WAIKOUAITI COAST
COMMUNITY
LG-071-2016-COM-1**

**WEST HARBOUR
COMMUNITY**

**OTAGO PENINSULA
COMMUNITY
LG-071-2016-COM-3**

Land District: Otago

**DUNEDIN CITY
WEST HARBOUR COMMUNITY**

TERRITORIAL AUTHORITY: Dunedin City
Compiled by Jacobs New Zealand Limited
Scale 1:75,000 at A3 Date: June 2016

LG-071-2016-Com-2
Sheet 1 of 2

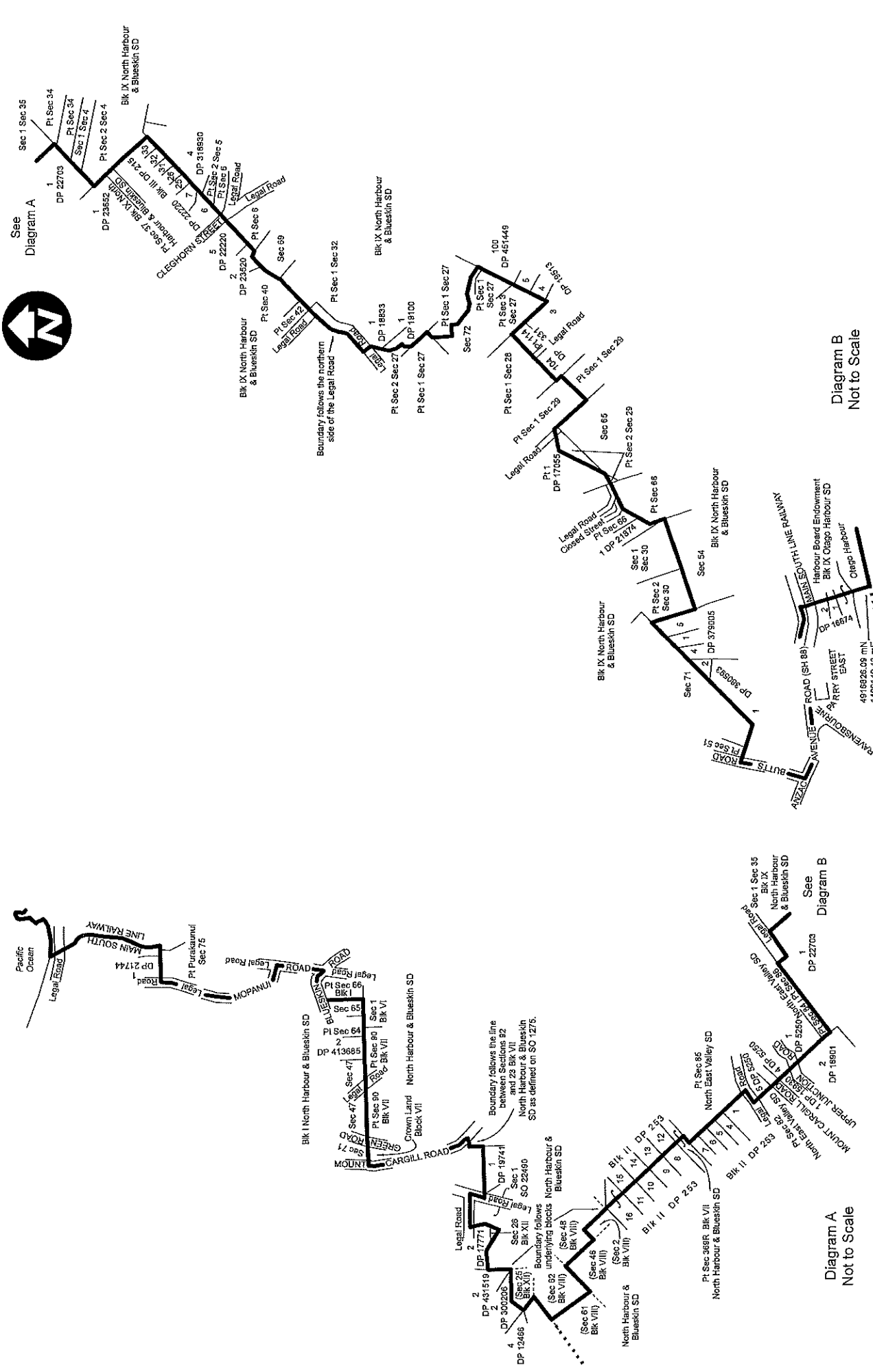

See
Diagram A

Diagram B
Not to Scale

Diagram A
Not to Scale

| | | | |
|----------------------|--|---|--|
| Land District: Otago | <h2 style="text-align: center;">DUNEDIN CITY WEST HARBOUR COMMUNITY</h2> | TERRITORIAL AUTHORITY: Dunedin City Compiled by Jacobs New Zealand Limited Not to Scale | LG-071-2016-Com-2 Sheet 2 of 2 |
| | | Date: June 2016 | |

Notes:

1. Coordinates are in terms of New Zealand Transverse Mercator 2000 (NZTM).
2. Where a boundary is shown along a river or road it follows the middle line of the physical river or legal road unless otherwise shown.
3. Where a boundary is shown along a railway it follows the middle line of the cadastral railway unless otherwise shown.
4. All seaward boundaries follow the line of mean low water springs but cross the mouths of all rivers, streams, inlets and estuaries unless otherwise shown.

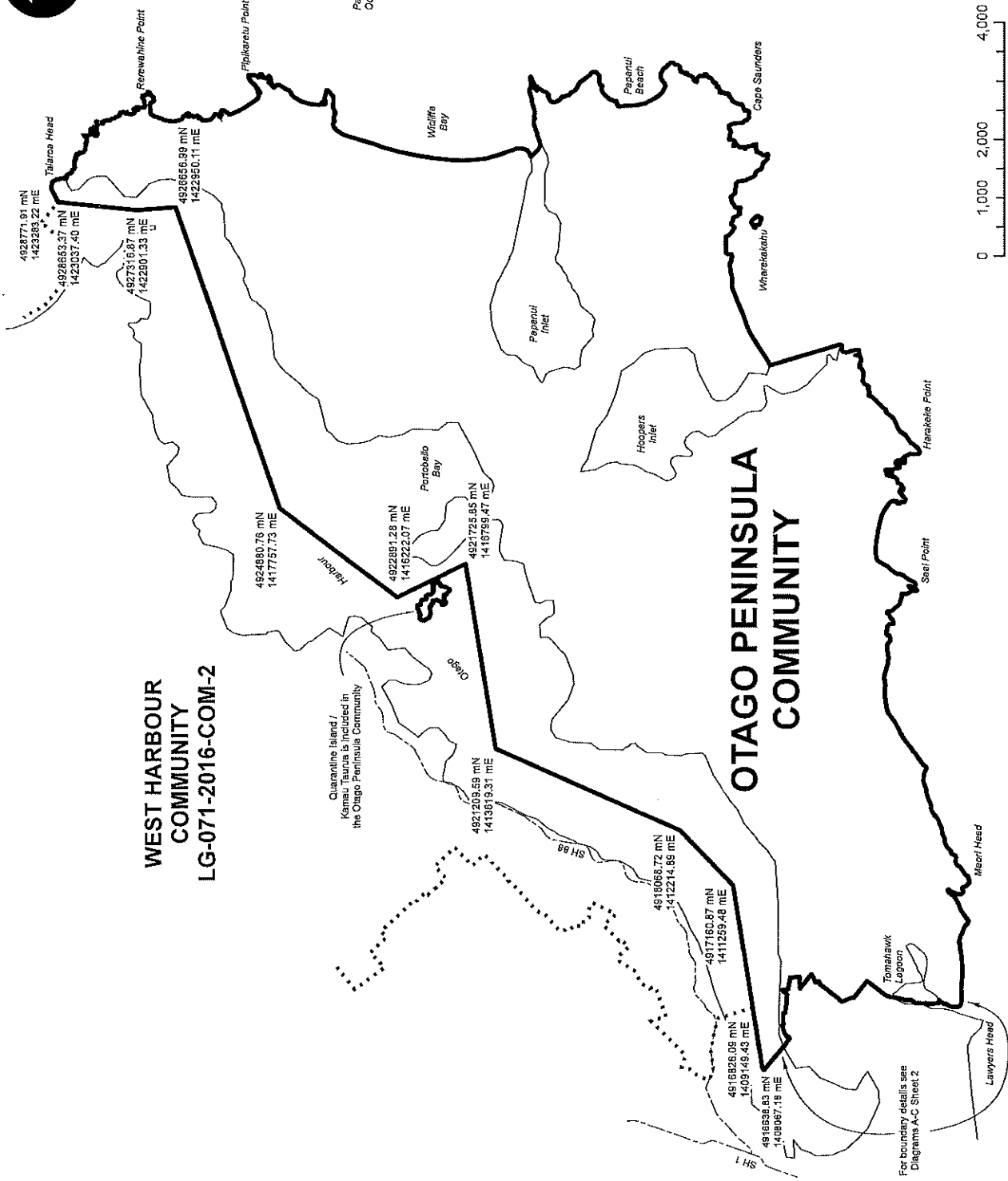

**WEST HARBOUR
COMMUNITY
LG-071-2016-COM-2**

**OTAGO PENINSULA
COMMUNITY**

Land District: Otago

**DUNEDIN CITY
OTAGO PENINSULA COMMUNITY**

TERRITORIAL AUTHORITY: Dunedin City
Compiled by Jacobs New Zealand Limited
Scale 1:70,000 at A3 Date: June 2016

LG-071-2016-Com-3
Sheet 1 of 2

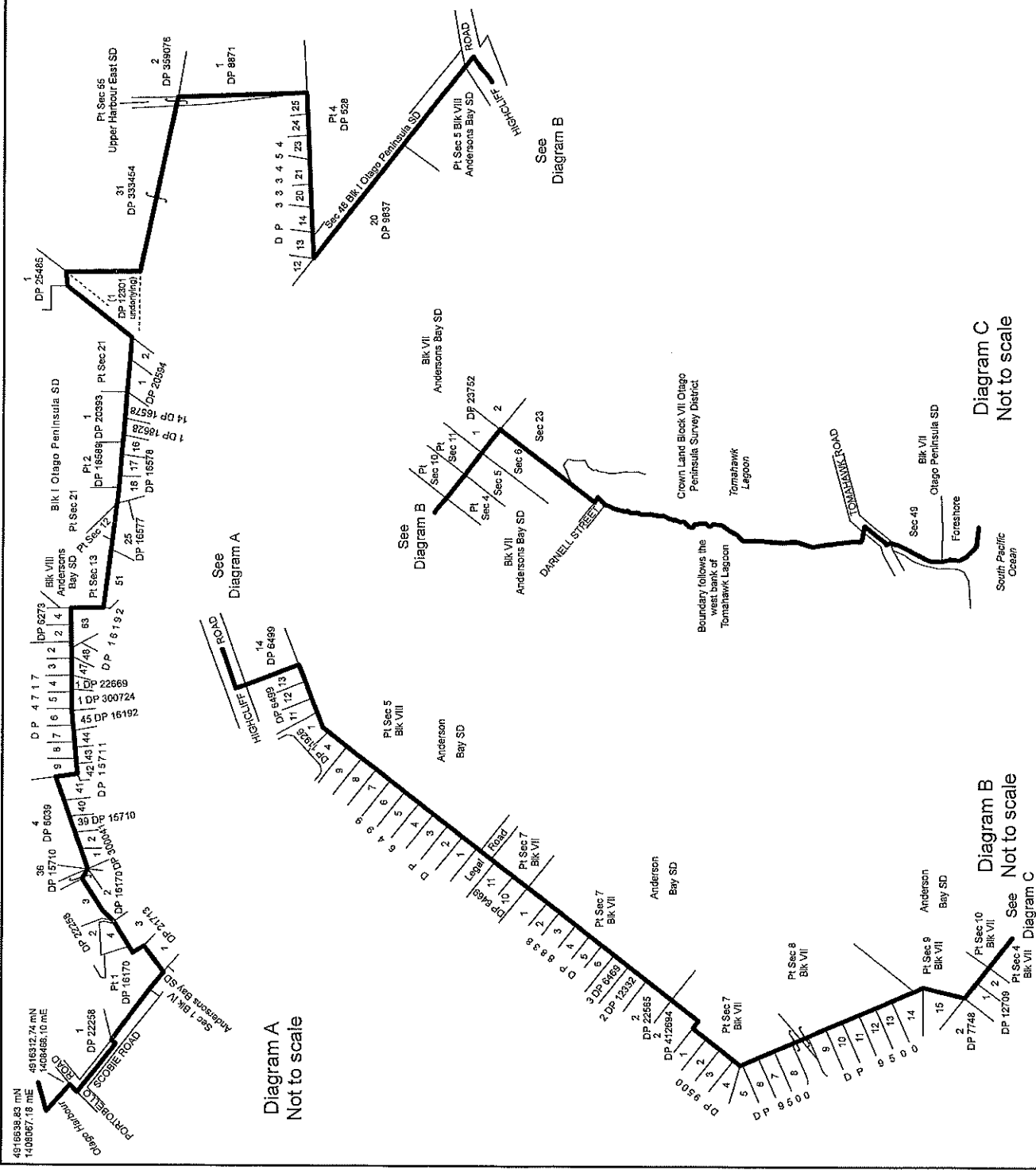

Diagram A
Not to scale

Diagram B
Not to scale

Diagram C
Not to scale

Land District: Otago

DUNEDIN CITY OTAGO PENINSULA COMMUNITY

TERRITORIAL AUTHORITY: Dunedin City
Compiled by Jacobs New Zealand Limited
Not to scale
Date: June 2016

I certify that the plans numbered LG-071-2016-Com-1, LG-071-2016-Com-2 & LG-071-2016-Com-3 renders the boundaries capable of identification for the purposes of section 19Y(3)(b) of the Local Electoral Act 2001.

Gary Regaldo  8 / 7 / 2016
Technical Advisor – Survey Land Information New Zealand

Pursuant to a delegation from the Surveyor-General under section 8 of the Cadastral Survey Act 2002

I certify that the boundaries shown on the plans numbered:

- LG-071-2016-Com-1, LG-071-2016-Com-2 and LG-071-2016-Com-3 are the same as the boundaries determined by the Local Government Commission on 7 April 2016 pursuant to section 19R of the Local Electoral Act 2001.

The plans listed above replace the following existing plans:

- SO 303092, SO 335080 and SO 335085

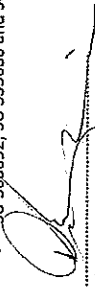

Donald Riezebos
Principal Advisor, Local Government Commission

4 July 2016



SO 430133 (Title Plan)

City - 01/01, Pages - 001, 16/08/10, 13



DocID: 21697380

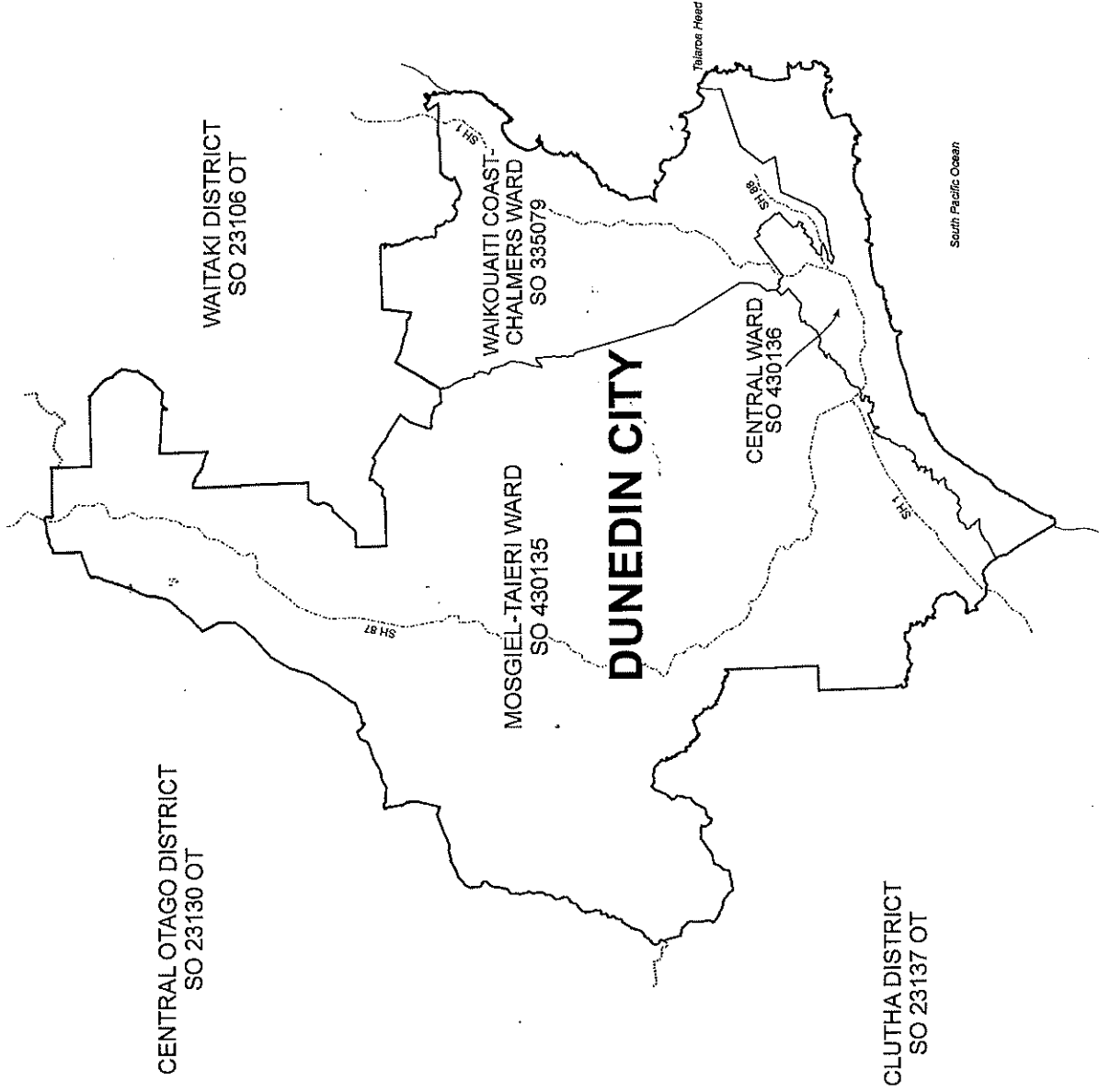

Descriptive Plan

TERRITORIAL AUTHORITY: DUNEDIN CITY
Compiled by Sinclair Knight Merz Ltd
Scale

Land District : Otago

Date May 2010

Approvals

Where a boundary is shown along a river or road, it follows the middle line of the physical river or legal road unless otherwise shown.

Where a boundary is shown along a railway it follows the middle line of the cadastral railway unless otherwise shown.

All seaward boundaries follow Mean Low Water Springs but cross the mouths of all rivers, streams, inlets and estuaries unless otherwise shown.

Certified by the Local Government Commission that the boundary shown hereon is the same as the determination dated 26/03/2010 pursuant to section 19R(1)(b) Local Electoral Act 2001.

Chief Executive Officer
Local Government Commission
8 6 2010

I certify that this plan renders the boundary capable of identification under section 19Y(3)(b) Local Electoral Act 2001.

17 05 2010
Surveyor General

This plan supersedes SO 335075.

Total Area

Comprised in:

being a person entitled to practise as a licensed cadastral surveyor, certify that -

(a) The surveys to which this dataset relates are accurate, and comply with the Survey Act 2002, in accordance with the Cadastral Survey Act 2002, and the Surveyor-General's Rules for Cadastral Survey 2002/2;

(b) This dataset is accurate, and has been created in accordance with that Act and those Rules

Field Book P. Traverse Book - A.

Reference Plans

Examined Correct

Approved as to Gazetted Purposes
by Lang Infocastigation NZ

Deposited this day of

for Registrar-General of Land

File Accessed Received Instructions

SO 430133